



VOLCANO TEC (THAILAND) CO., LTD.

COMPANY PROFILE

www.volcano.co.th

VOLCANO MILESTONE

1999

- Volcano Name Plate Sdn. Bhd., ("VNP") was incorporated to manufacturing of nameplates in Penang, Malaysia
- VNP commenced operations in a rented shop lot.

2002 - 2004

- VNP Secured its first order from Hewlett-Packard Asia Pacific Pte Ltd
- VNP moved its entire operations to its owned current factory

2008

- Volcano Tec (Thailand) Co. Ltd ("VTT") was incorporated to carry out the manufacturing of nameplates and plastic injection moulded parts, through a rented factory in Rayong, Thailand
- Smart partnership with Fisher & Paykel Thailand and commenced Plastic Injection business
- VTT was granted a promotion certificate with tax privileges by the Board of Investment of Thailand

2011

- Moved its operations in Thailand to a new manufacturing plant (owned plant) from its previously rented property to its current address

2021

- Volcano Berhad debuted on the ACE Market of the Bursa Malaysia Securities Berhad on 6 April 2021

2022-2023

- Acquired a 4.10 acre land in Rayong, Thailand for the VTT construction of a second factory (VTT2)
- Acquired a 1 acre land with a vacant one-storey factory and a two-storey office thereon in Bukit Tengah, Penang

COMPANY PROFILE OF VOLCANO (VTT)



Volcano Tec (Thailand) Co., Ltd.

Established : September 2008 under the full promotion of BOI

Subsidiary of : Volcano Berhad (Head Quarter)

The Volcano Berhad is a public listed company in Malaysia since 06 Apr 2021

Capital : THB 135 million

Total Asset Value: THB 320 million

Main Business : Plastic Injection, Name Plate, Printing Product's

Factory location : Amata City Rayong Industrial Estate

Approx. Production Area : 8,000 sqm.

Employees : 230 headcounts (31 Dec 2023)

Operation Time : 24 hr. x 5 days/week (2 shifts)



CERTIFICATE



IATF 16949 : 2016

Expiry 20 Mar 2027

ISO 9001 : 2015

Expiry 20 Mar 2027

ISO 14001 : 2015

Expiry 3 Feb 2027



CERTIFICATE

Certificate Registration No.: 12 111 67311 TMS / IATF Certificate No.: 0506694
IATF USI: 6KYCGR

The Certification Body of TÜV SÜD Management Service GmbH certifies that the organization

Volcano Tec (Thailand) Co.,Ltd.
7/ 298 Moo 6, Amata City Rayong Industrial Estate Road,
Soi Pornprapha, Tambol Mabyangporn, Amphur Pluakdaeng,
Rayong Province, 21140
Thailand

for the scope

Manufacture of Precision Plastic Injection Moulded and Assembled Part
(without Product Design as per Chapter 8.3)

has established and applies a Quality Management System.
An audit was performed and has furnished proof that the requirements according to

IATF 16949
First Edition 2016-10-01
are fulfilled.

Issue date: 2024-03-21
Expiry date: 2027-03-20



TÜV SÜD Management Service GmbH • Zertifizierungsstelle • Riederstrasse 57 • 80329 München • Germany
www.tuv.sud.com/de/certificate-validity-check



CERTIFICATE

Certificate Registration No.: 12 100 67311 TMS / Order No.: 721245764

The Certification Body of TÜV SÜD Management Service GmbH certifies that the organization

Volcano Tec (Thailand) Co.,Ltd.
7/ 298 Moo 6, Amata City Rayong Industrial Estate Road,
Soi Pornprapha, Tambol Mabyangporn, Amphur Pluakdaeng,
Rayong Province, 21140
Thailand

for the scope

Manufacture of Precision Plastic Injection Moulded, Assembled, Printed, Stamped, Tempo (Tempo Printed, Lasered, Silk Screened, Hot stamped), Spray Painted for Electronic part & Nameplate product

has established and applies a Quality Management System.
An audit was performed and has furnished proof that the requirements according to

DIN EN ISO 9001:2015
are fulfilled.

The certificate is valid from 2024-03-21 until 2027-03-20.



TÜV SÜD Management Service GmbH • Zertifizierungsstelle • Riederstrasse 57 • 80329 München • Germany
www.tuv.sud.com/de/certificate-validity-check





Certificate of Registration

ENVIRONMENTAL MANAGEMENT SYSTEM - ISO 14001:2015

This is to certify that:

Volcano Tec (Thailand) Co., Ltd. 7/298 Moo 6, Amata City Rayong Industrial Estate, T. Mabyangporn, A. Pluakdaeng, Rayong 21140 Thailand	บริษัท โวลคาโน เทคโนโลยี (ไทยแลนด์) จำกัด 7/298 หมู่ 6 ถนนในเขตอุตสาหกรรมเอมตาซิตีระยอง ตำบลแม่เปิน อำเภอเมืองระยอง จังหวัดระยอง 21140 ประเทศไทย
---	--

Holds Certificate Number: **EMS 742350**

and operates an Environmental Management System which complies with the requirements of ISO 14001:2015 for the following scope:

The Manufacture of Electronic & Automotive Parts and Nameplate Products by Precision Plastic Injection Moulding, Assembling, Printing, Stamping, Tempo (Tempo Printing, Lasering, Silk Screening & Hot Stamping), Spray-Painting and UV Printing Processes.

การดำเนินงานผลิตพลาสติกและอุปกรณ์อิเล็กทรอนิกส์โดยกระบวนการฉีดพลาสติก
การประกอบชิ้นส่วนพลาสติก การพิมพ์ การตัด การเคลือบสี (การเคลือบสีด้วย
การพ่นสี การเคลือบสีด้วยสีผงและการเคลือบสีด้วยสีเหลว) และการพิมพ์ด้วยเลเซอร์
และการพ่นสีด้วยสีผง

For and on behalf of BSI:



Michael Lam - Managing Director Assurance, APAC

Original Registration Date: 2011-06-10	Effective Date: 2024-02-04
Latest Revision Date: 2023-12-20	Expiry Date: 2027-02-03

Page: 1 of 1

...making excellence a habit™

This certificate was issued electronically and remains the property of BSI and is bound by the conditions of contract.
An electronic certificate can be authenticated [here](https://www.bsi.com/ClientDirectory).
Printed copies can be validated at www.bsi.com/ClientDirectory or telephone +44 (0) 294891952.
Further clarifications regarding the scope of this certificate and the applicability of ISO 14001:2015 requirements may be obtained by consulting the organization.
This certificate is valid only if provided original copies are in complete set.

Information and Contact: BSI, Marton Court, Davy Avenue, Knowlhill, Milton Keynes MK5 8PP, UK. Tel: +44 (345) 080 9000
BSI Assurance UK Limited, registered in England under number 7805321 at 389 Chiswick High Road, London W4 4AL, UK.
A Member of the BSI Group of Companies.

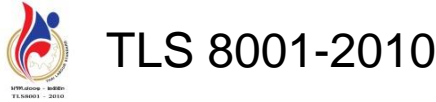

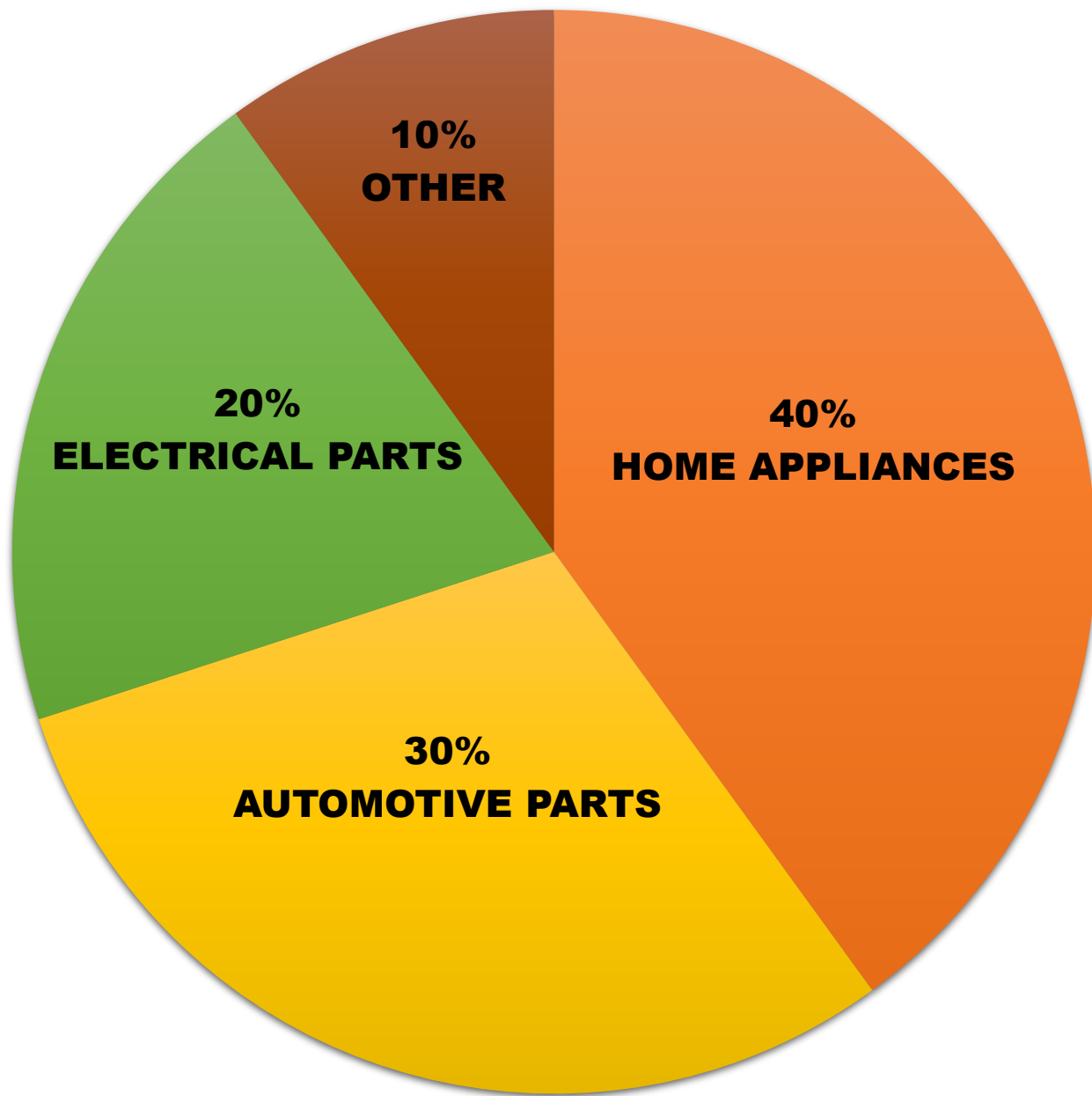

MARKET SHARE Y2023

QUALITY MEASURING EQUIPMENT



CMM - XYZ (ZEISS)



Micro VU (CMM)



Vision Measuring Machine



Image Dimension (Keyence)

QUALITY MEASURING EQUIPMENT

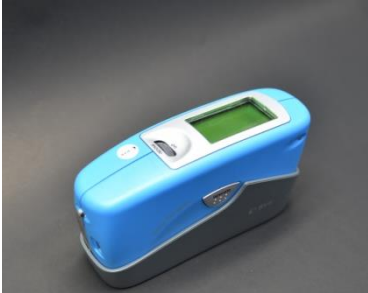

Micro Gloss Meter



Digital force Gauge



Chroma Meter



Thickness Gauge



Digital Light Meter



Coating Thickness Meter



Durometer



Micrometer



Radius Gauge



Digital Angle Meter



Gauge Block



Torque Wrench 10 N



Pencil hardness tester



Color Assessment cabinets



Pin Gauge

INJECTION MACHINES LIST

Item	Machine Tonnage	Brand	Model	Robotic Arm
1	25	ENGEL	ES80/25HL	Yushin-ATC150S
2	25	ENGEL	ES80/25HLS	Yushin-ATC150S
3	30	ENGLE	ES80/30HL	Yushin-ATC150S
4	40	NISSEI	PNX40 III-5A	Yushin-SC-70DL
5	50	ENGEL	ES80/50HL	Yushin-ATC150D
6	50	SHIBAURA	EC50SXIII	STAR ES-650SII
7	100	SHIBAURA	EC100SXIII	STAR ES-650SII
8	100	SHIBAURA	EC100SXIII	STAR JX-650S
9	100	SHIBAURA	EC100SXIII	STAR JX-650S
10	125	ENGEL	ES500/125H	Yushin ATC-150D
11	130	SHIBAURA	EC130SXIII	STAR JX-650S
12	130	SHIBAURA	EC130SXIII	STAR ES-650SII
13	150	ENGEL	VC650/150 POWER	Yushin ATC-150D
14	180	TOSHIBA	EC180SX	STAR ES-800SII
15	180	SHIBAURA	EC180SX	STAR ES-800SII
16	180	NISSEI	FNX180IIIT-36A	Yushin ATC-150D
17	180	NISSEI	FNX180IIIT-36A	Yushin ATC-150D
18	250	CHEN HSONG	SM 250	Yushin ATC-150D
19	250	CHEN HSONG	SM 250	Yushin ATC-150D
20	280	SHIBAURA	EC280SX	STAR ES-800SII-18
21	350	CHEN HSONG	SM 350	STAR ES-800SII
22	350	CHEN HSONG	SM 350	Yushin ATCII-300D
23	380	HAITAIN	MA3800/2250	Yushin SC-350S
24	470	HAITIAN	MA4700/2950	Yushin SC-350S
25	480	LIGUANG	FL-480ES	STAR ES-1200SII
26	700	HAITIAN	MA7000/5000	Yushin SAll-6000SL
27	800	HAITIAN	MA8000/6800	Yushin SAll-850S



Total 27 Injection Machines with robotic arms

PLASTIC INJECTION

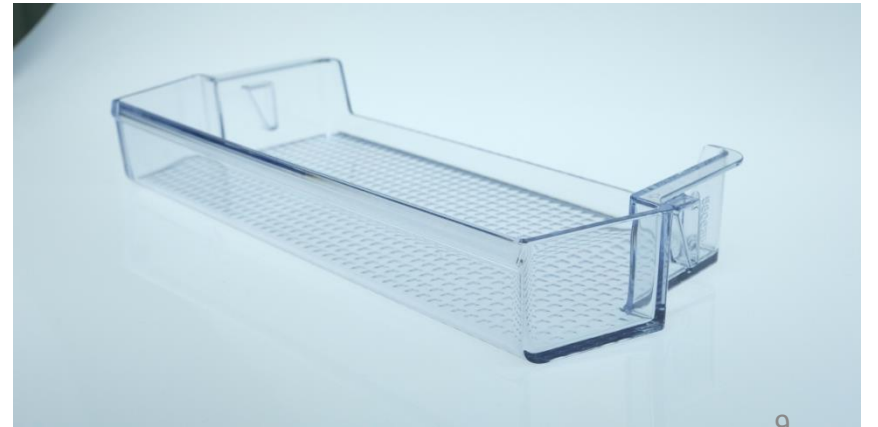
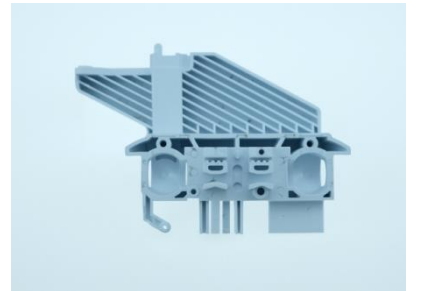
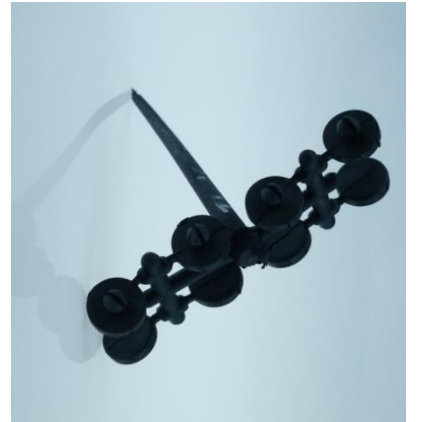
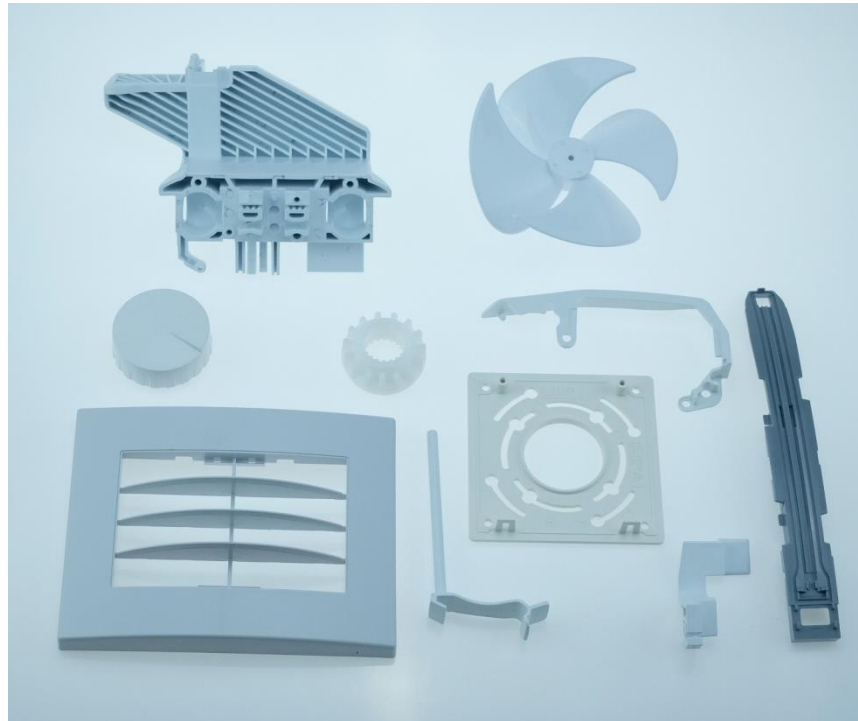

SUB ASSEMBLY





SUB ASSEMBLY



SPRAY PAINTING

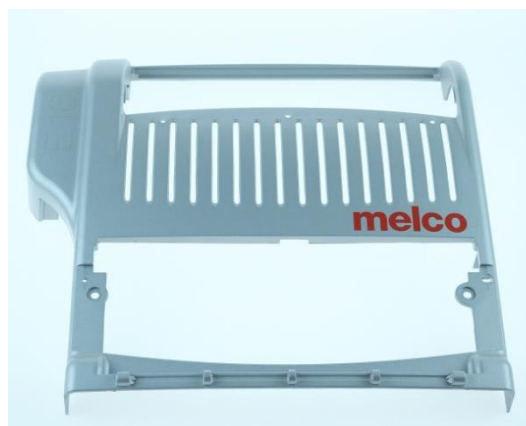

TOOL SHOP

Milling Machine



Grinding Machine



EDM Machine



Lathe Machine

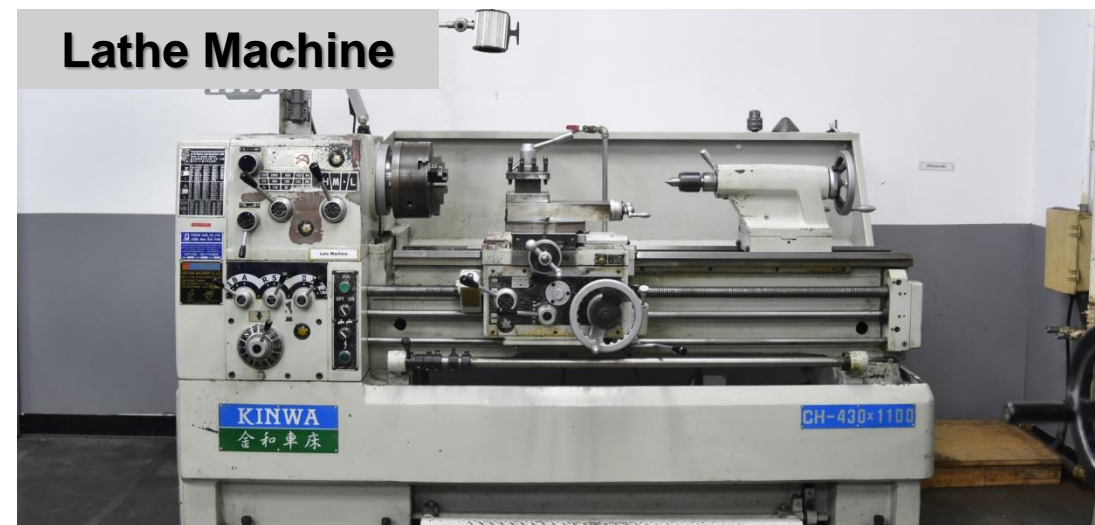



DIAMOND CUTTING

SILK SCREEN PRINTING

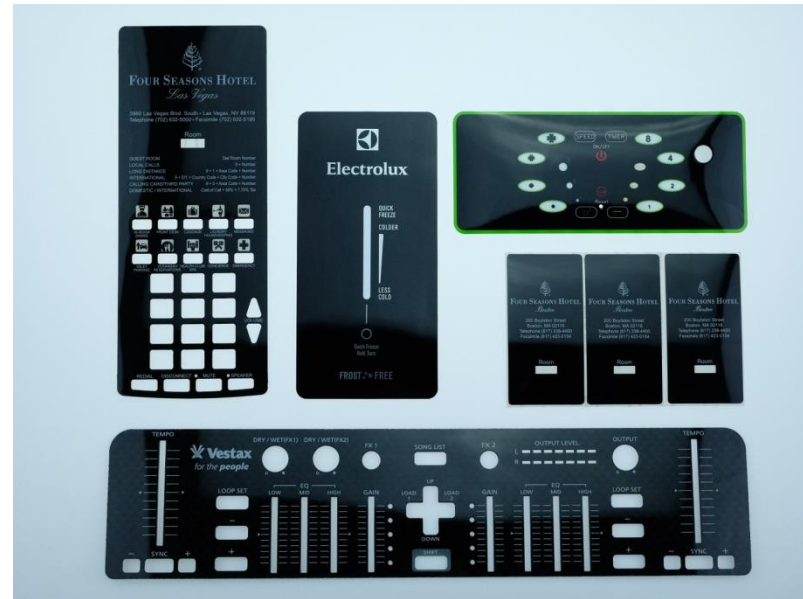

PAD PRINTING



8 Color PAD PRINT



UV INKJET PRINTING



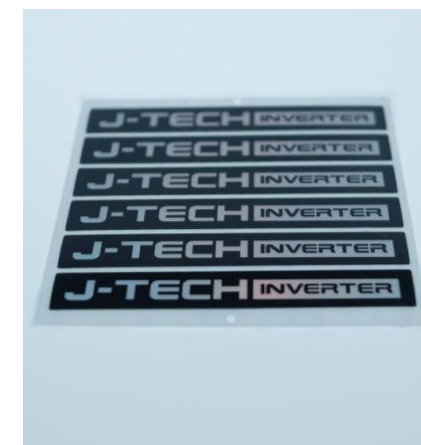
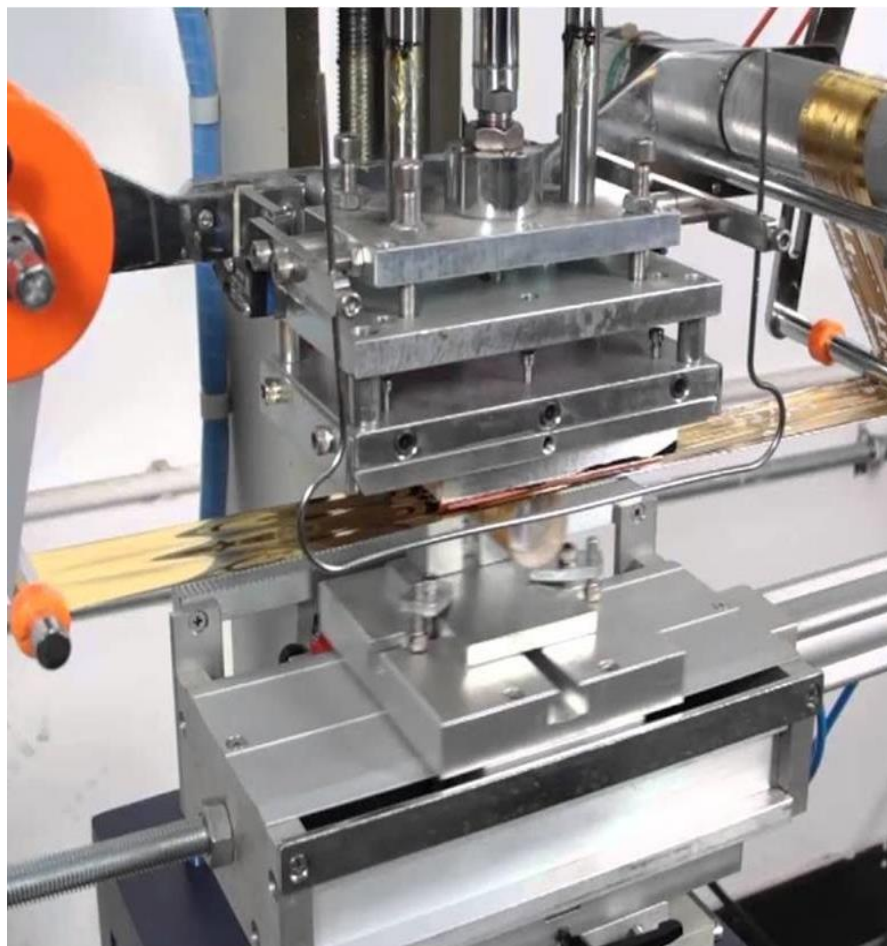

HOT STAMPING

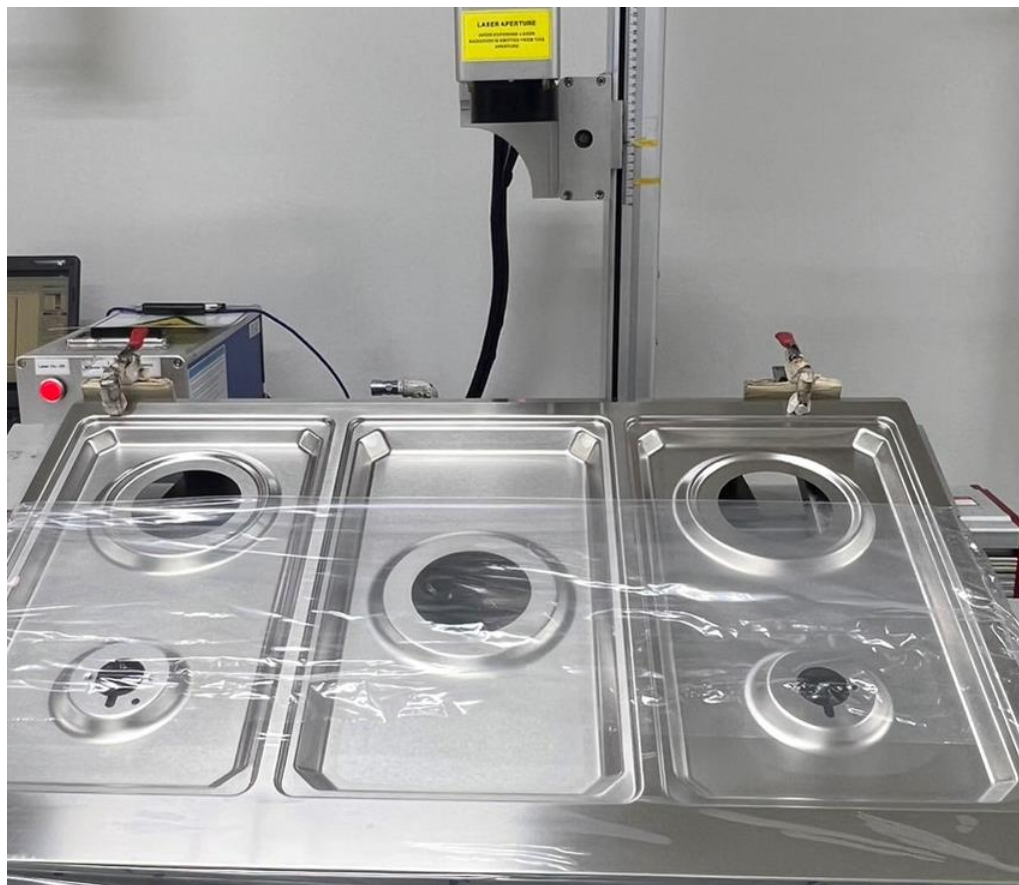

LASER ENGRAVING

LASER CUTTING

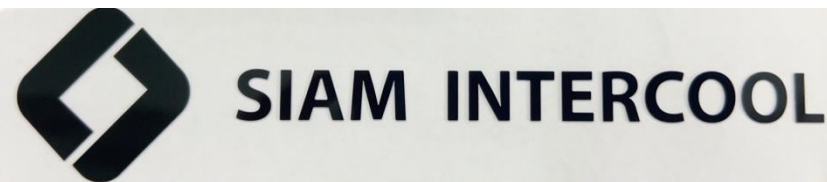

PU / EPOXY RESIN



STAMPING

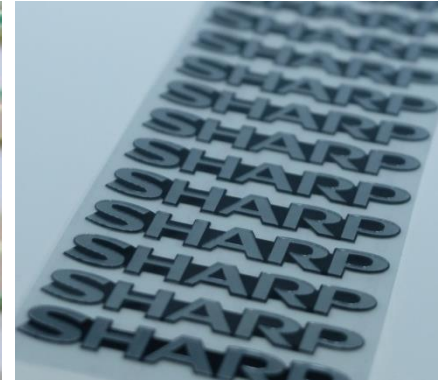
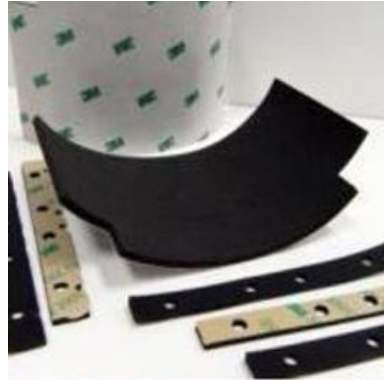

NICKEL ELECTRO FORMING

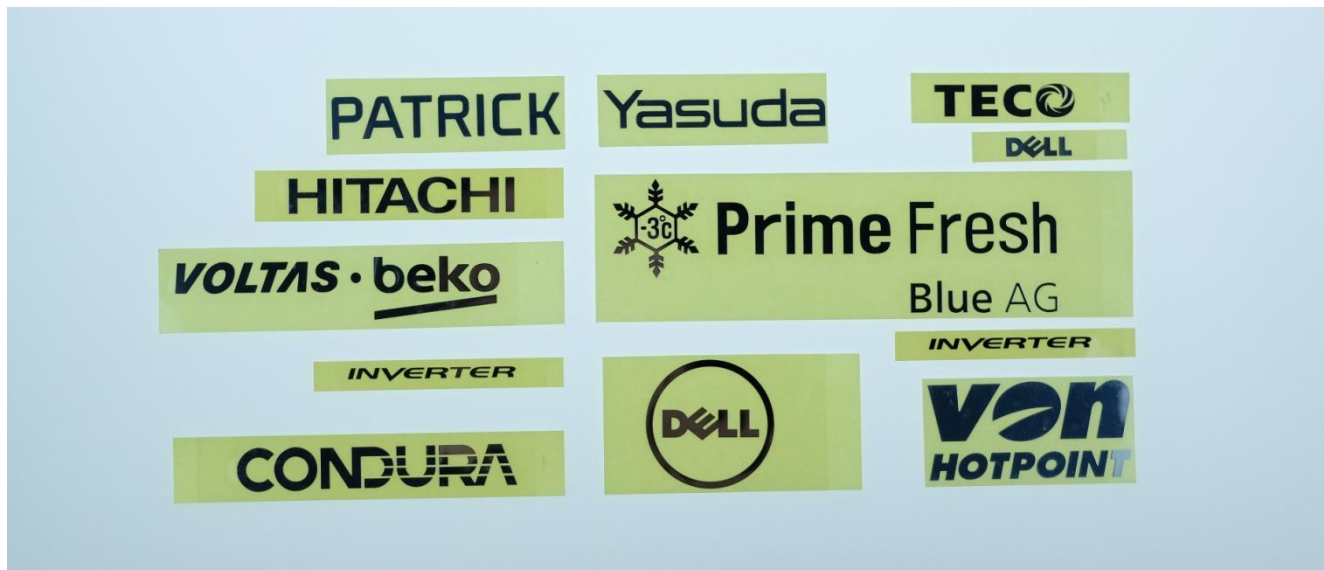

METAL EMBLEM





MEMBRANES SWITCH PANEL

3D SOFT EMBLEM.



WAREHOUSE & LOGISTIC

1. SAP System
2. First-In-First-Out Racking System
3. Product Handling Equipment
4. Material Code Identification
5. Returnable Box
6. Flexible Delivery / Trucking Service





**OUR VALUABLE
CUSTOMERS**

OUR VALUABLE CUSTOMERS



Home Appliances



Automotive



E&E



Others



Future Expansion (VTT2)

VTT2 LOCATION

- **Distance** : VTT1 to VTT2 is 5.3 kilometer
- **Take time**: about 10 minutes



VTT2 CONCEPT BUILDING

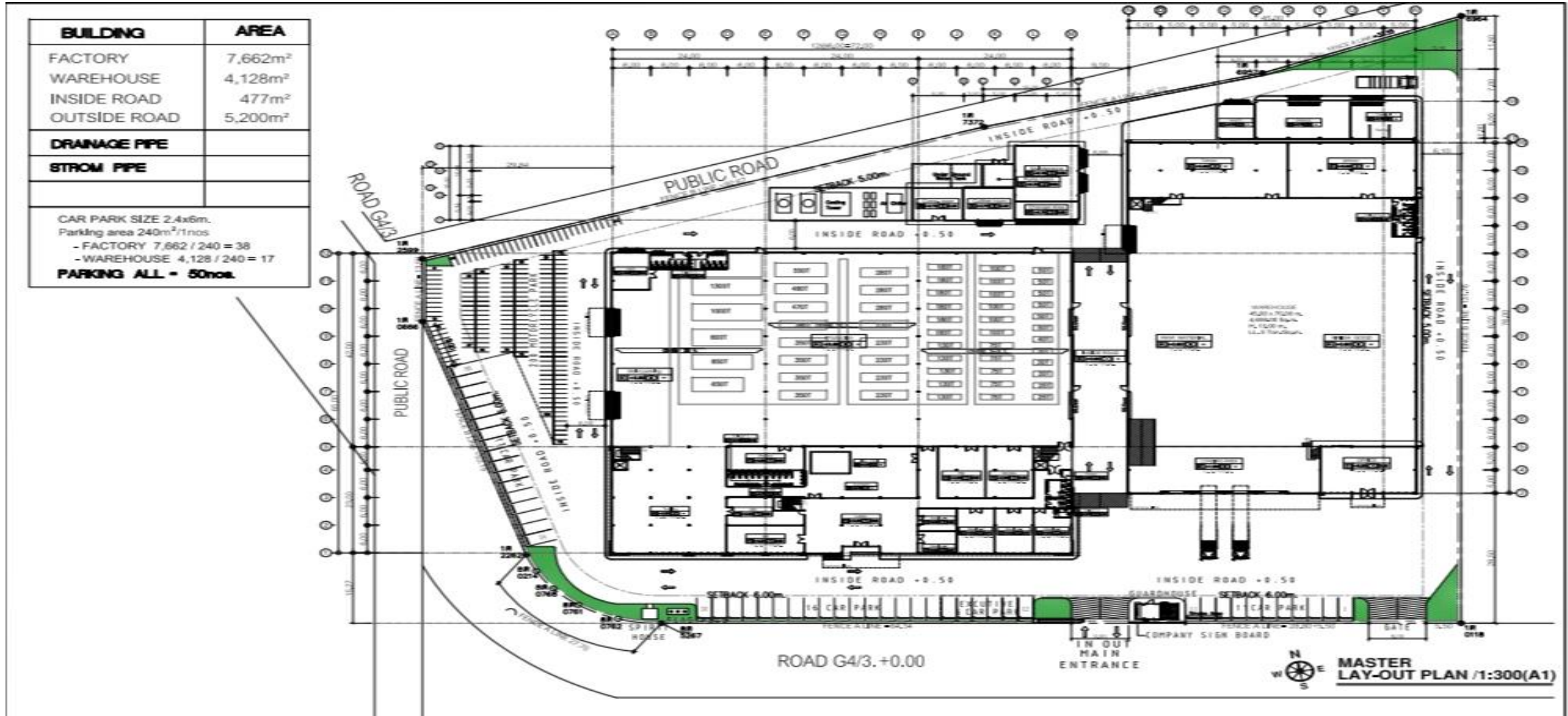

		PROJECT NEW FACTORY AND OFFICE. LOCATION Areas city along industrial estate	<input checked="" type="checkbox"/> FOR APP. <input type="checkbox"/> FOR CON. <input type="checkbox"/> AS BUILT	NOTE THE OWNER IS RESPONSIBLE FOR ALL INFORMATION AND DATA. ALL INFORMATION ON THIS DRAWING IS BASED ON THE INFORMATION PROVIDED BY THE CLIENT AND THE DESIGNER HAS CONDUCTED VISUAL CHECK ONLY. NO FIELD SURVEY OR INVESTIGATION WAS CONDUCTED. THE DESIGNER IS NOT RESPONSIBLE FOR ANY ERRORS OR OMISSIONS. THE CLIENT IS ADVISED TO VERIFY ALL INFORMATION BEFORE PROCEEDING.	<table border="1"> <thead> <tr> <th>NO.</th> <th>DATE</th> <th>DESCRIPTION</th> <th>PREPARED BY</th> <th>CHECKED BY</th> </tr> </thead> <tbody> <tr> <td> </td> <td> </td> <td> </td> <td> </td> <td> </td> </tr> </tbody> </table>	NO.	DATE	DESCRIPTION	PREPARED BY	CHECKED BY						PROJECT TITLE MASTER LAY-OUT PLAN	DESIGNER VOLCANO TEC (THAILAND) CO. LTD. SCALE 1:300 (A1)	APPROVAL SIGNATURE (Signature) APPROVAL SIGNATURE (Signature)	PROJECT NO. VTT2-001 DATE 2024-08-08 SCALE 1:300 (A1)
NO.	DATE	DESCRIPTION	PREPARED BY	CHECKED BY															

VTT2 CONCEPT BUILDING - INJECTION MACHINE LAYOUT

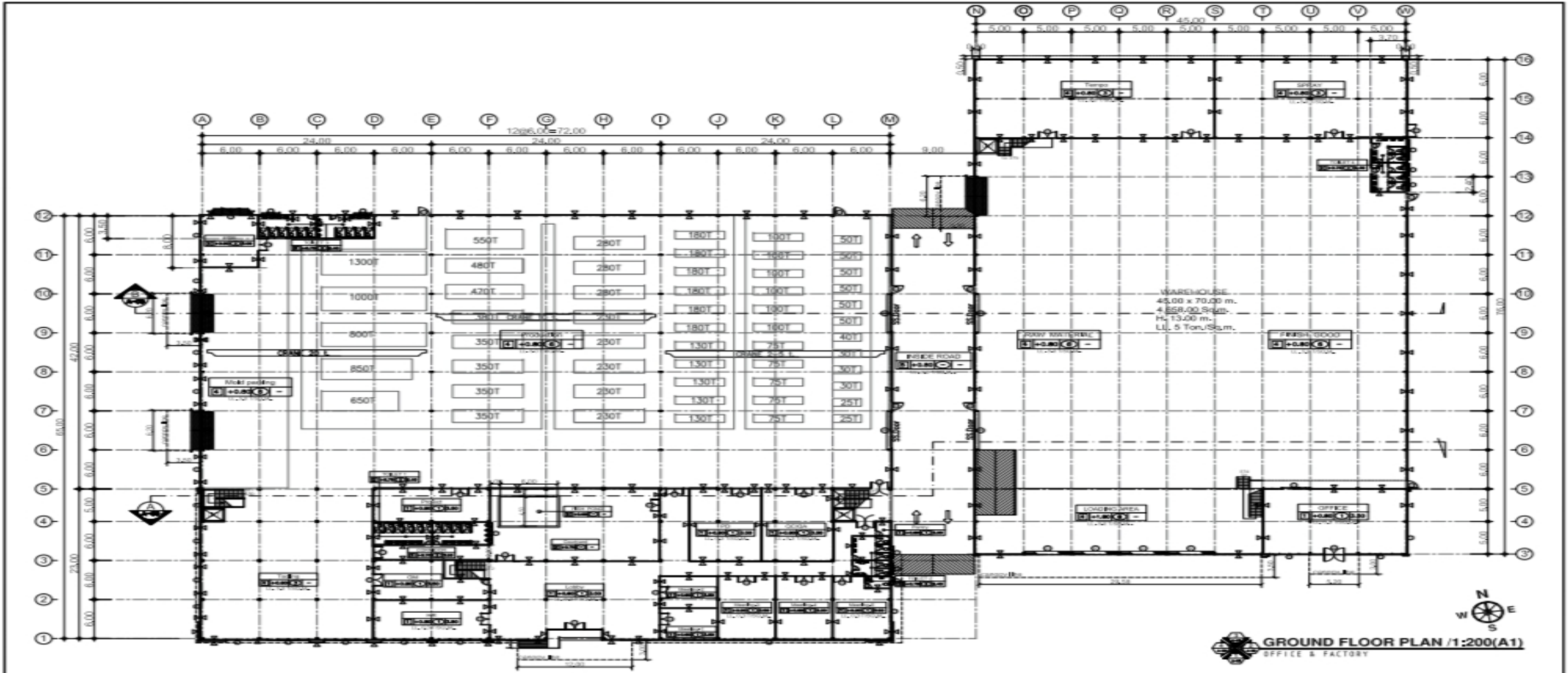

GROUND FLOOR PLAN /1:200(A1)
OFFICE & FACTORY

<p>JHK JHK CONSULTANT CO.,LTD. 100/100 Lakhon Road, Bangkok Tel: 02-2524271 / 02-2524272</p>	<p>VOLCANO VOLCANO TEC (THAILAND) CO.,LTD.</p>	PROJECT NEW FACTORY AND OFFICE	<input checked="" type="checkbox"/> FOR APP. <input type="checkbox"/> FOR CON. <input type="checkbox"/> AS BUILT	NOTE THIS DRAWING IS SUBJECT TO ALL APPLICABLE CODES AND ALL INFORMATION IN THIS DRAWING IS FOR INFORMATION ONLY AND NOT TO BE USED FOR ANY OTHER PURPOSE WITHOUT THE WRITTEN PERMISSION OF THE CONSULTANT.	NO. 	DATE 	DESCRIPTION 	FOR SET DATE 	APPROVED BY [Signature] PROJECT MANAGER	STRUCTURAL ENGINEER [Signature] [Name]	MECHANICAL ENGINEER [Signature] [Name]	ELECTRICAL ENGINEER [Signature] [Name]	DATE 11/10/2024	NO. A-04
		LOCATION Arakho city rayong industrial estate	REVISION 	FOR SET DATE GROUND FLOOR PLAN	APPROVED BY [Signature] PROJECT MANAGER	MECHANICAL ENGINEER [Signature] [Name]	ELECTRICAL ENGINEER [Signature] [Name]	DATE 11/10/2024	NO. A-04					

VTT2 CONCEPT BUILDING (FRONT VIEW)

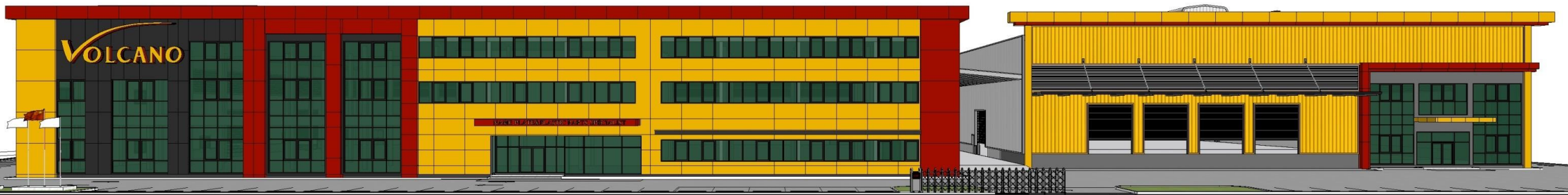

VTT2 CONCEPT BUILDING (FRONT VIEW)



VTT2 CONCEPT BUILDING (SIDE VIEW)



VTT2 CONCEPT BUILDING (TOP VIEW)





NEW INDONESIA OFFICE

INDONESIA OFFICE

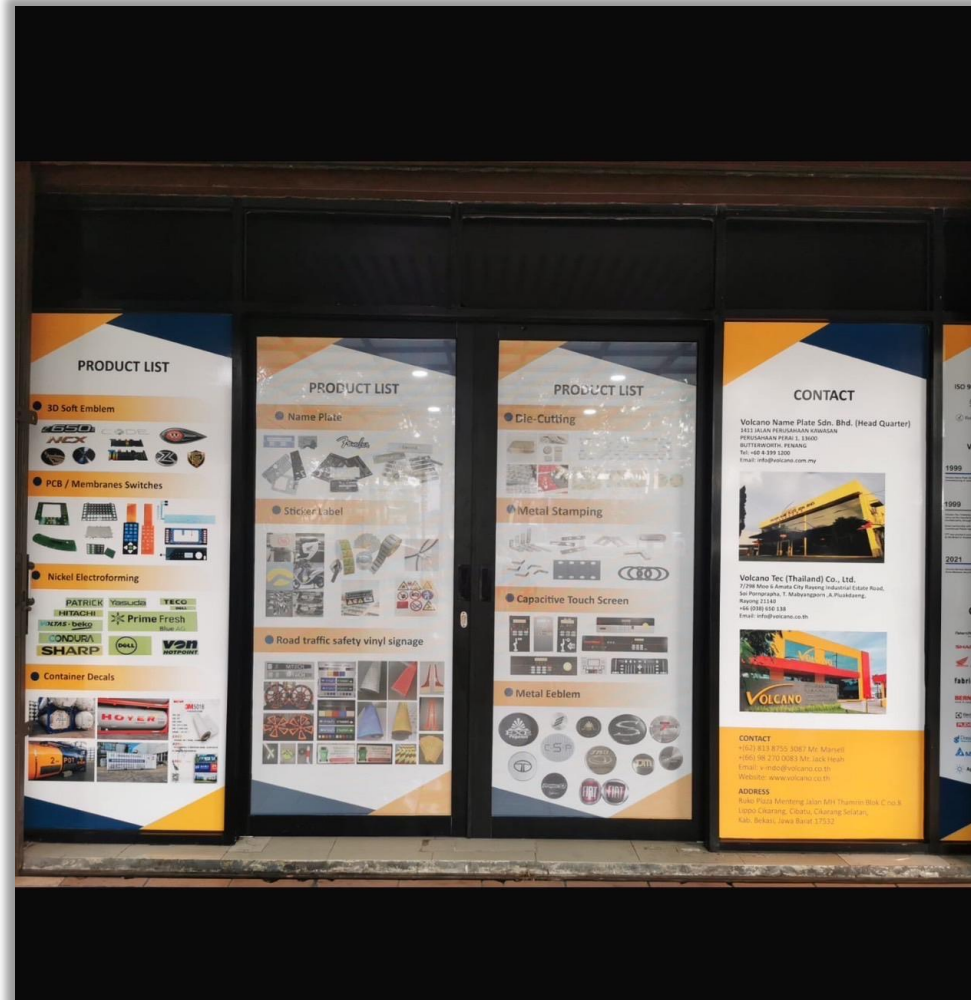

NEW CHIANGMAI OFFICE

CHIANGMAI OFFICE (FRONT VIEW)



CHIANGMAI OFFICE (SIDE VIEW INSIDE)



CHIANGMAI OFFICE (TOP VIEW INSIDE)

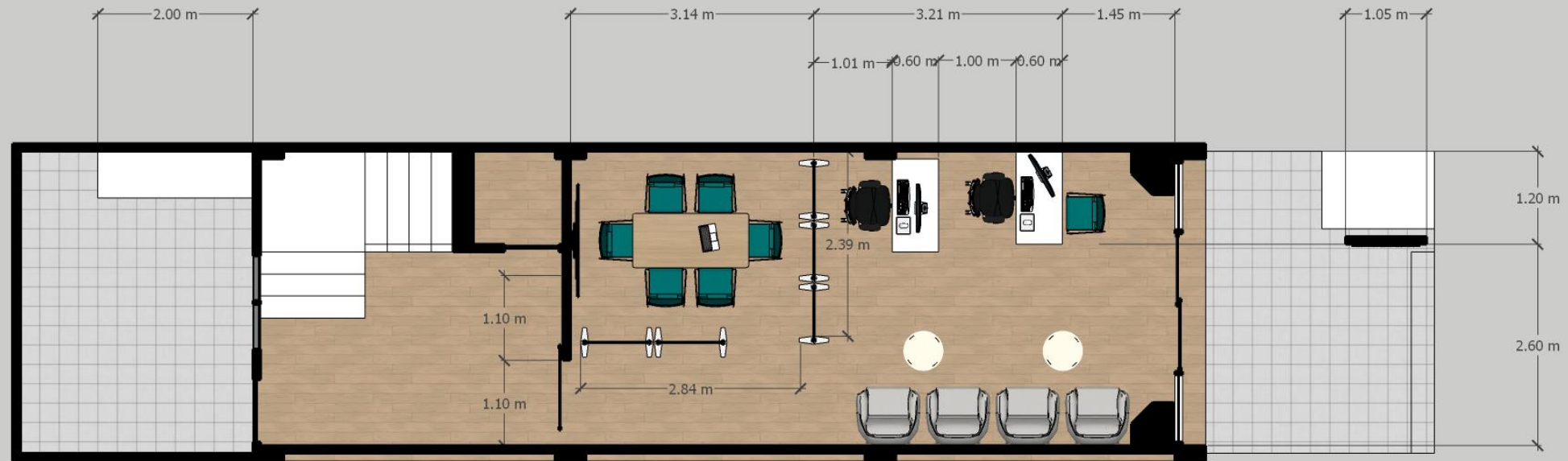

WE DELIGHT THE CUSTOMERS

THANK YOU